



WINTER



Designed to maximise on storage

This great one bedroom home has been designed with functionality in mind and to maximise on storage. Features a galley kitchen and an open lounge and dining area. The alfresco is situated behind the carport, providing privacy when entertaining.

- No stamp duty
- No council rates
- No strata fees
- 6 star energy efficiency rating

Make your move to Vibe Baldivis Lifestyle Village for over 50s and be spoilt for choice on how to fill your days with all the social events, resort style facilities and so much more.

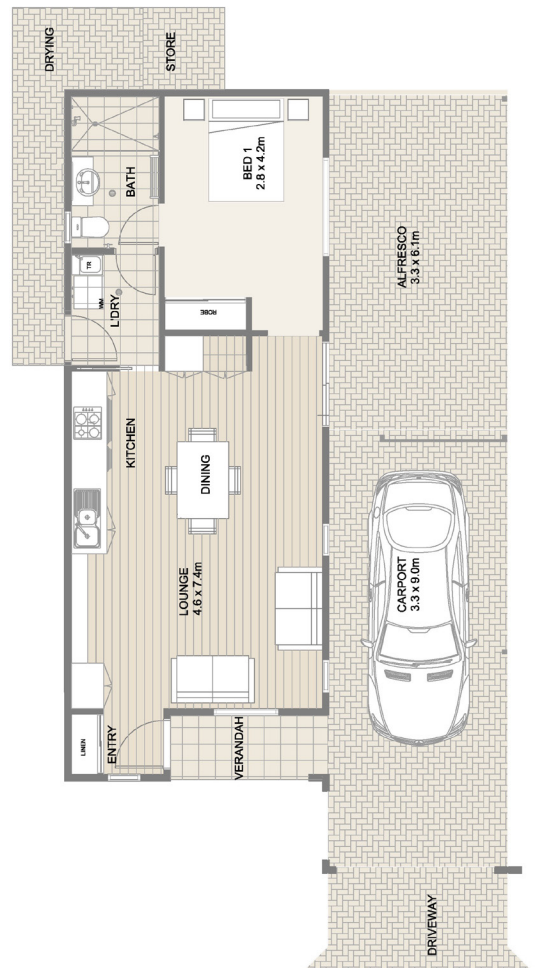

Disclaimer: The information contained in this brochure was correct and up to date at the time of printing, and may be subject to change at any time. Landscaping may vary depending on the site. These images are indication only. There is no expressed or implied representation, warranty or guarantee that it is complete, accurate or reliable. We may vary or modify the information, pricing or the images at any time without prior or subsequent notice.

Sales office open Monday to Friday 8:30am-4pm
08 9524 4403 | vibebaldivis@nlv.com.au
nlv.com.au

